

Shot Fire C925 Clip



Shot-fired hanger solution with pre-mounted nail end fixing for suspending Mechanical or Electrical services in an indoor stationary setting. NOT suitable for use in chlorinated / swimming pool environments.

APPLICATION / MATERIAL SPECS

For shot-firing into concrete, or concrete over metal deck. Can be installed with gas and powder-actuated tools (VIPER4, DX351, and P3500. Also Powers Sniper, PA3500, P35S, PA351, and P60). For use with a No.1 or No.2 Gripple cable hanger.

Material Specifications

Cable: Galvanized high tensile steel cable to EN12385.
Standard lengths from 5ft-30ft, other lengths can be made to order.

	No. 1	No. 2
Cable Dia. (in.)	1/16"	5/64"
Strand configuration	7x7	7x7

Shot Fire Clip: Steel - .08" (2.0 mm) thick

Shot Fire Pin: Galvanized Steel

SHOT FIRE C925

Cable crimped around an C925 shot fire clip*

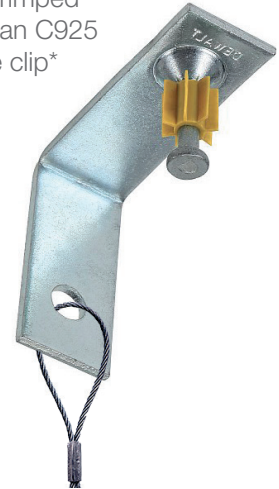

SIZE SPECS

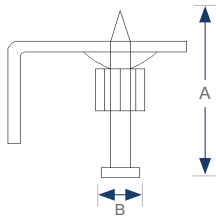

Dimensions	Size (in.)
A (shank length)	1"
B (head diameter)	0.3"

INSTALLATION

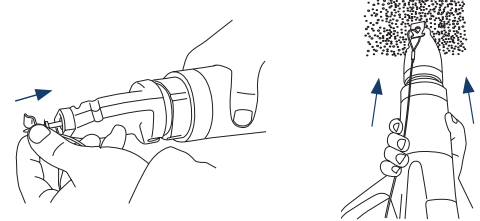

SAFE WORKING LOADS (with a minimum embedment depth of at least 3/4")*

3/4" Embedment

C925 Shot Fire Clip in CONCRETE 5:1 Safety Factor	Minimum Concrete Compressive Strength (f'c)		
	2000 psi	3000 psi	4000 psi
Normal Weight Concrete	40 lbs	125 lbs	190 lbs

7/8" Embedment

C925 Shot Fire Clip in CONCRETE 5:1 Safety Factor	Minimum Concrete Compressive Strength (f'c)		
	2000 psi	3000 psi	4000 psi
Normal Weight Concrete	40 lbs	160 lbs	200 lbs

3/4" Embedment

C925 Shot Fire Clip in STEEL DECK into CONCRETE w/ 3 in. deep profile 5:1 Safety Factor	Minimum Concrete Compressive Strength (f'c)		
	2000 psi	3000 psi	4000 psi
Lightweight Concrete, over 20 gage Deck- Lower Flute + Upper Flute		50 lbs	

7/8" Embedment

C925 Shot Fire Clip in STEEL DECK into CONCRETE w/ 3 in. deep profile 5:1 Safety Factor	Minimum Concrete Compressive Strength (f'c)		
	2000 psi	3000 psi	4000 psi
Lightweight Concrete, over 20 gage Deck- Lower Flute + Upper Flute		80 lbs	

* Also refer to fastener load ratings and safety factors.

PI-SHOTFIREC925-US
Digital AUG 2022

www.gripple.com

Gripple's policy is one of continuous development and innovation. We therefore reserve the right to alter specifications, etc. without notice.



Gripple Inc | 1611 Emily Lane | Aurora, IL 60502 | USA

Tel +1 866 474 7753 Fax +1 800 654 0689 Email grippleinc@gripple.com