

Shot Fire SF35 Clip



Shot-fired hanger solution with pre-mounted nail end fixing for suspending Mechanical or Electrical services in an indoor stationary setting. NOT suitable for use in chlorinated / swimming pool environments.

APPLICATION / MATERIAL SPECS

For shot-firing into concrete, or concrete over metal deck. Can be installed with gas and powder-actuated tools (VIPER4, DX351, and P3500. Also Powers Sniper, PA3500, P35S, PA351, and P60). For use with a No.1 or No.2 Gripple cable hanger.

Material Specifications

Cable: Galvanized high tensile steel cable to EN12385.
Standard lengths from 5ft-30ft, other lengths can be made to order.

	No. 1	No. 2
Cable Dia. (in.)	1/16"	5/64"
Strand configuration	7x7	7x7

Shot Fire Clip: Steel - .08" (2.0 mm) thick

Shot Fire Pin: Galvanized Steel

SHOT FIRE SF35

Cable crimped around an SF35 shot fire clip*



SIZE SPECS

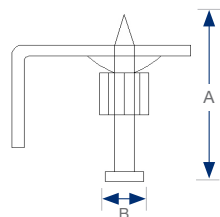

Dimensions	Size (in.)
A (shank length)	1 1/4"
B (head diameter)	0.3"

INSTALLATION

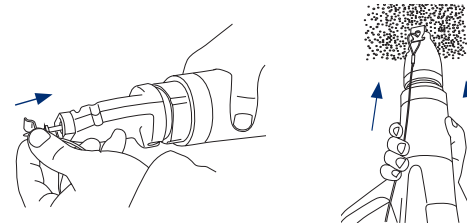

SAFE WORKING LOADS (with a minimum embedment depth of at least 1")*

1" Embedment

SF35 Shot Fire Clip in CONCRETE 5:1 Safety Factor	Minimum Concrete Compressive Strength (f'c)		
	2000 psi	3000 psi	4000 psi
Normal Weight Concrete	40 lbs	75 lbs	100 lbs

1 1/8" Embedment

SF35 Shot Fire Clip in CONCRETE 5:1 Safety Factor	Minimum Concrete Compressive Strength (f'c)		
	2000 psi	3000 psi	4000 psi
Normal Weight Concrete	40 lbs	95 lbs	100 lbs

1" Embedment

SF35 Shot Fire Clip in STEEL DECK into CONCRETE w/ 3 in. deep profile 5:1 Safety Factor	Minimum Concrete Compressive Strength (f'c)		
	2000 psi	3000 psi	4000 psi
Lightweight Concrete, over 20 gage Deck- Lower Flute + Upper Flute		130 lbs	145 lbs

1 1/8" Embedment

SF35 Shot Fire Clip in STEEL DECK into CONCRETE w/ 3 in. deep profile 5:1 Safety Factor	Minimum Concrete Compressive Strength (f'c)		
	2000 psi	3000 psi	4000 psi
Lightweight Concrete, over 20 gage Deck- Lower Flute + Upper Flute		130 lbs	145 lbs

* Also refer to fastener load ratings and safety factors.

PI-SHOTFIRESF35-US
Digital OCT 2022

www.gripple.com

Gripple's policy is one of continuous development and innovation. We therefore reserve the right to alter specifications, etc. without notice.



Gripple Inc | 1611 Emily Lane | Aurora, IL 60502 | USA

Tel +1 866 474 7753 Fax +1 800 654 0689 Email grippleinc@gripple.com